

PHOENIX Audio Technologies

Sennheiser SL Ceiling Microphone Guide

* Note that this solution is only certified to be used with Zoom or Skype for Business applications

The Sennheiser SL Ceiling Microphone integrates perfectly with the Stingray MT700 for video conferencing via Zoom and Skype for Business. We suggest only using the Sennheiser SL Ceiling Mic with the Stingray for USB audio for best performance.

CONNECTING THE SL MIC



The SL Mic has three connectors on the back: CONTROL, POWER, and AUDIO OUT.

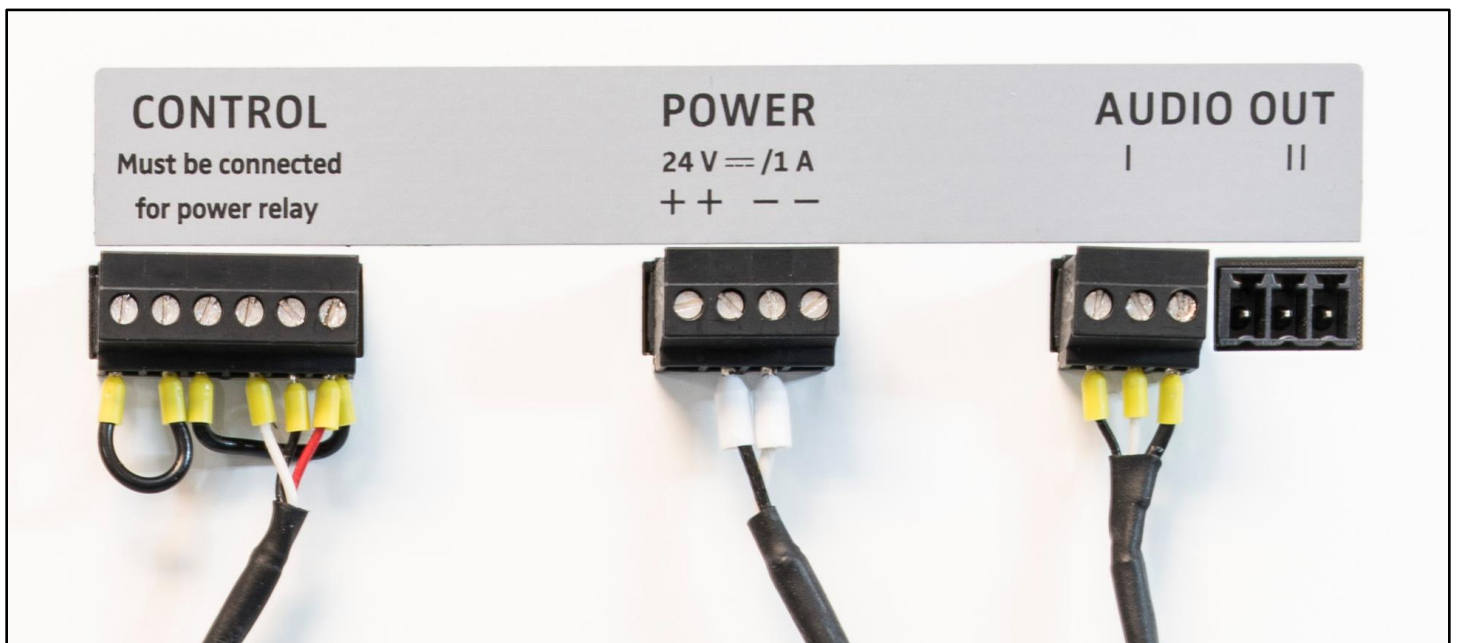

1. Connect the supplied CONTROL cable to the microphone (6-Pin Black Connector).
 - As a note, the CONTROL cable is not in use when using the Stingray. The cable is required to be connected to the microphone to turn on.

2. Connect the supplied POWER cable to the microphone (4-Pin Black Connector).



3. Connect the supplied AUDIO OUT cable to the microphone (3-Pin Black Connector).

4. Remove the grey 3-position connector from the opposite end of the supplied AUDIO OUT cable with a screwdriver.

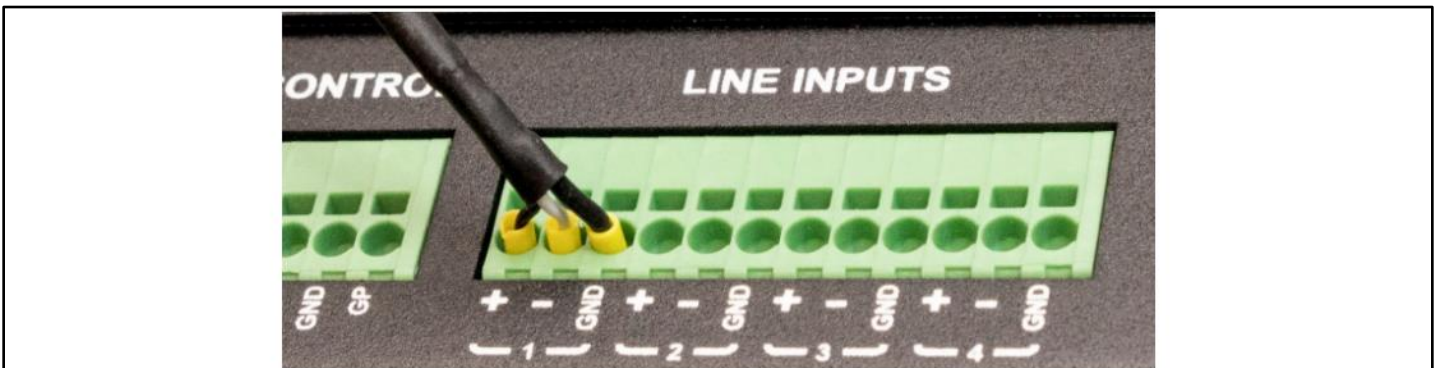

5. Push the wires from the grey 3-position connector into the first of the “Line Inputs” on the Stingray, as shown in the image.

- Thin Black (+ : Positive)
- Thin White (- : Negative)
- Thick Black (GND : Ground)

i The Stingray’s Phoenix Connectors are push-in connections which require no tools for installation. If removal of the wire is required, insert a screwdriver into the rectangular hole above the wire for release.



In addition to the SL Ceiling Microphone, the Stingray will also need to have either amplified speakers or up to four unamplified wire 8ohm speakers in order to use the full functionality of the DSP.

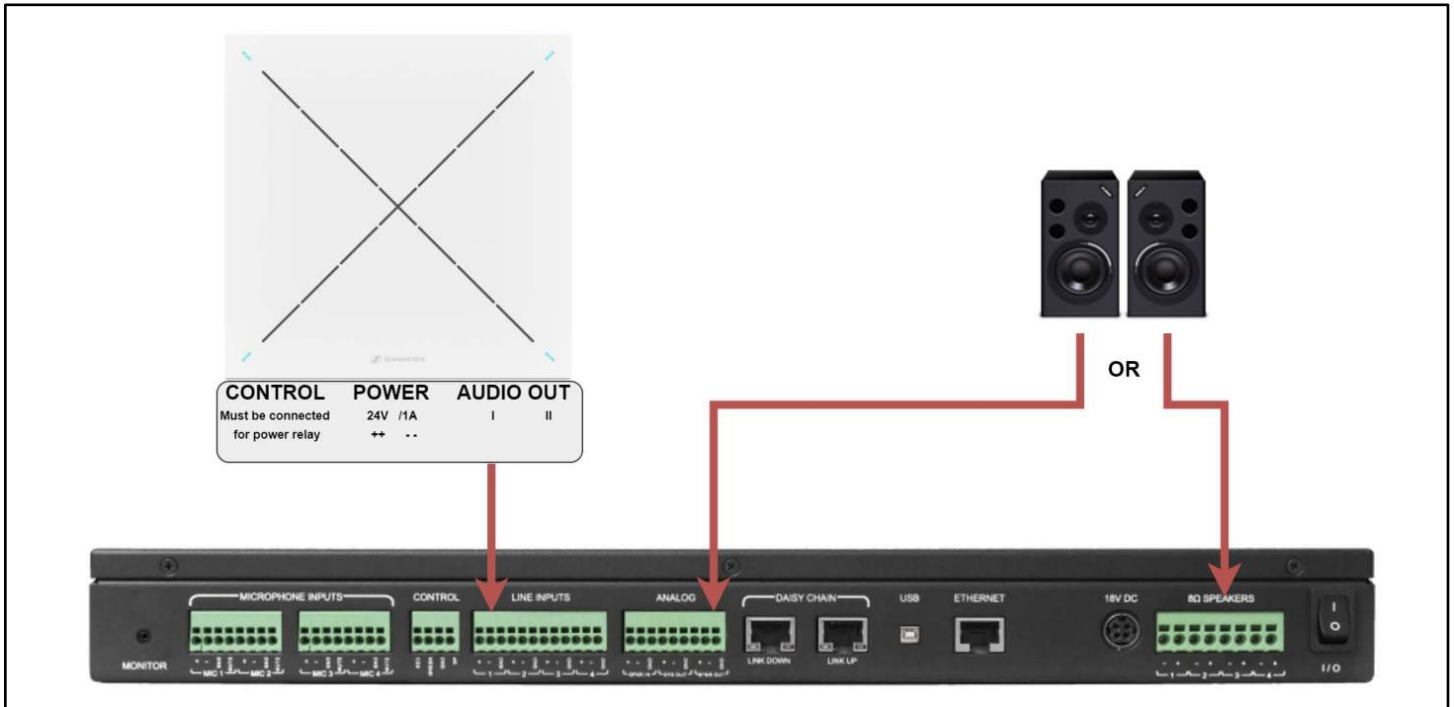

Amplified speakers will need to be connected to the “Analog/Speaker Out” connector.

OR

Up to four unamplified wire 8ohm speakers (15W maximum per channel) will need to be connected to the Stingray’s built-in amplifier.

SETTING UP THE STINGRAY



The only setup necessary is changing the Stingray's mixer setting to line mixer. This can be done through the front panel or through the Stingray's setup GUI.

Stingray Front Panel

1. From the front panel, enter the menu. Scroll down to the second menu item, "automatic mixer selection."



2. Press Enter and select "mix line input."



3. Press Enter again. Select the line use for the Sennheiser SL Ceiling Mic and set it to the "mixer" option.

Stingray GUI

1. After logging into the IP address of the Stingray, select “Device Setup.”

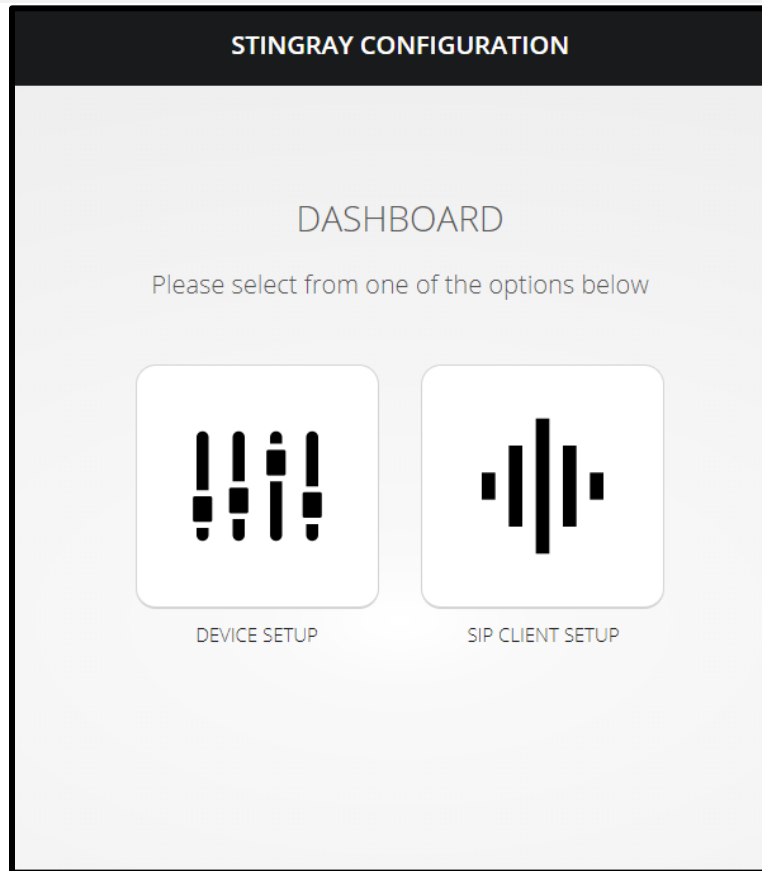

2. Select the primary unit and then “Edit Primary Parameters”.

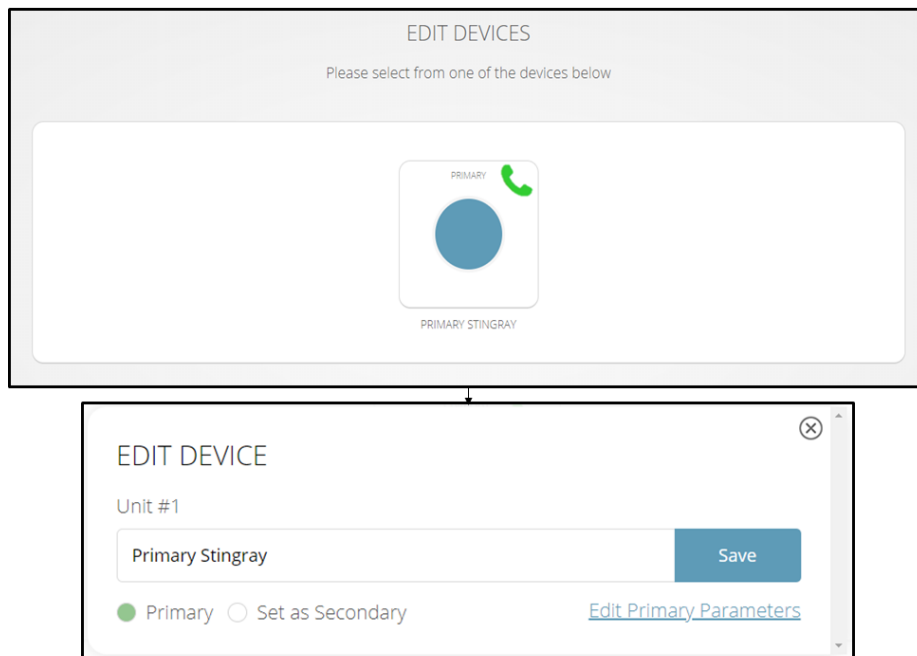

3. Within the “Edit Primary Parameters” page, select “LINE MIXER”.

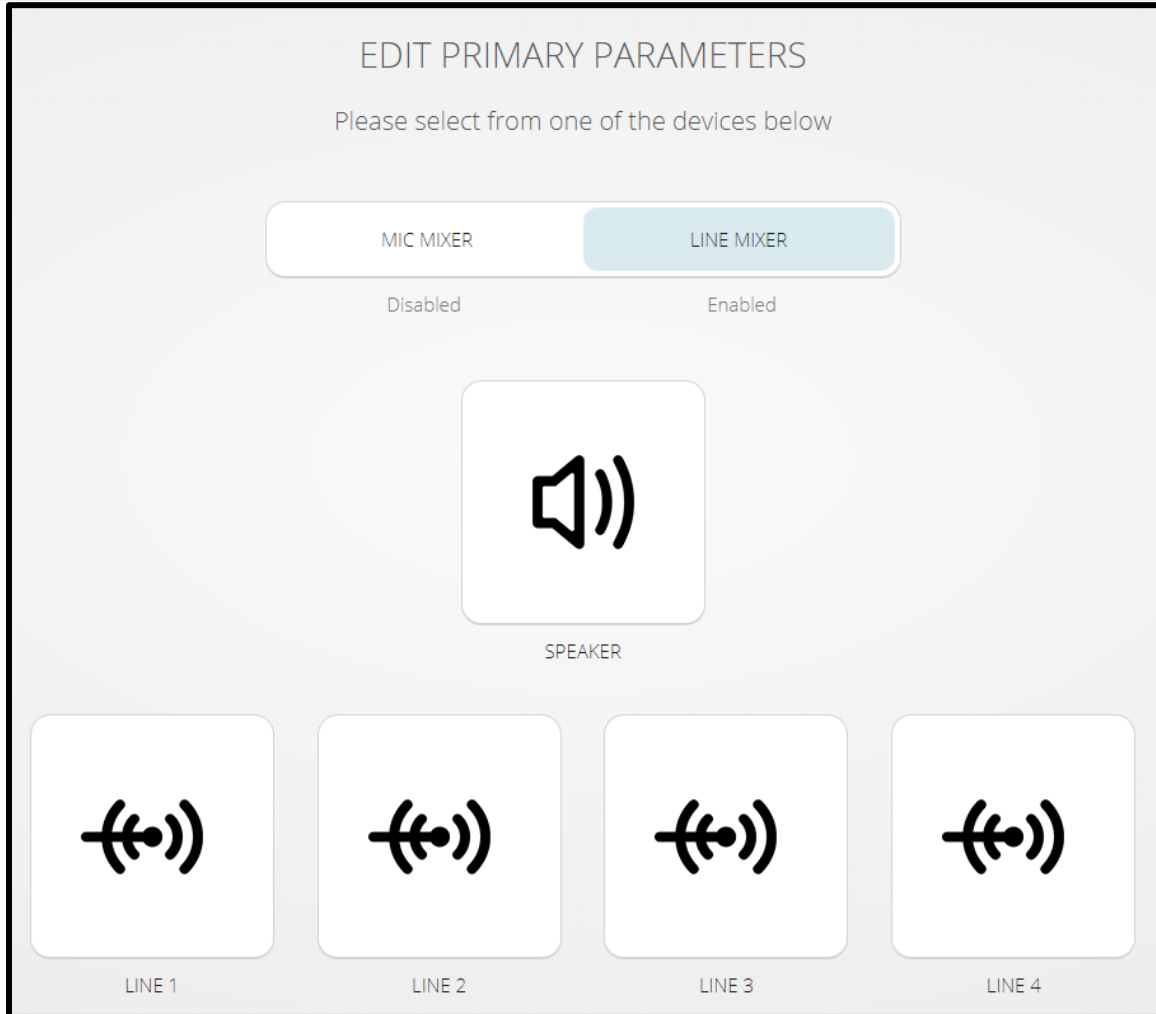

4. Line settings appear at the bottom of the “Edit Primary Parameters” page. Select the line used for the Sennheiser SL Ceiling Mic and set it to the “MIXER” option.

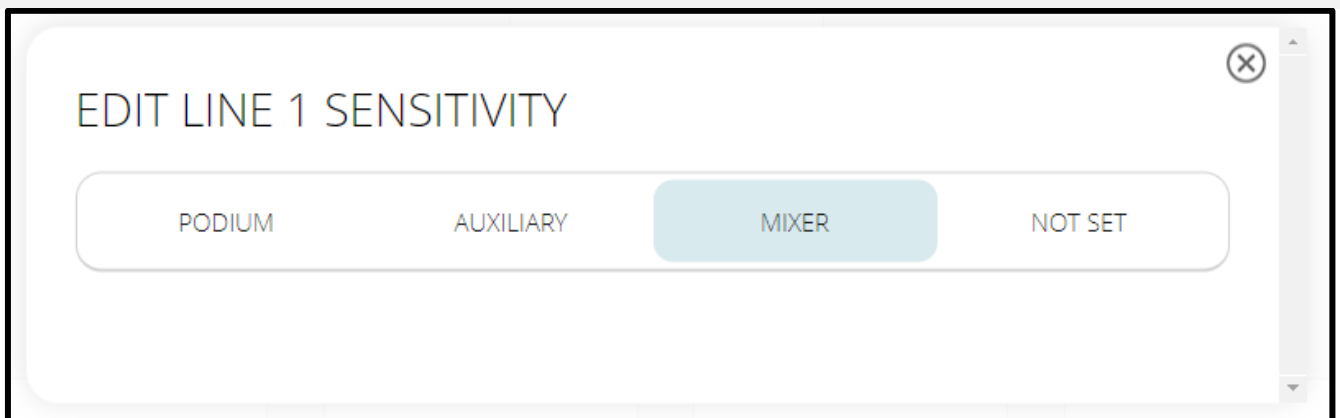

For setup assistance or any additional technical questions, contact Phoenix Audio Technical Support at (818) 937-4779 or email us at support@phnxaudio.com.